

HEAT PUMPS



THE PEOPLE'S CHOICE OF HEAT PUMPS

Our customers voted for us! We're proud to have won Consumer's People's Choice Award for the heat pump category for two years in a row. The award, presented by New Zealand's leading independent consumer advocacy group, recognises products and services that stand out for customer satisfaction and is based on customer satisfaction surveys from a representative sample across New Zealand.



MITSUBISHI HEAVY INDUSTRIES HEAT PUMPS NEW ZEALAND

Mitsubishi Heavy Industries Heat Pumps is a trusted supplier of premium residential and commercial air conditioning and heat pump systems to the New Zealand market. Delivering engineering excellence for over 140 years, the Mitsubishi Heavy Industries brand is instantly recognisable for quality and technological advancement.

With innovation central to both the organisation and the development of heat pump systems, Mitsubishi Heavy Industries carries a strong philosophy of engineering products that are designed to improve the lives of those who use them and, at the same time, create a sustainable future for our company and the world we live in.

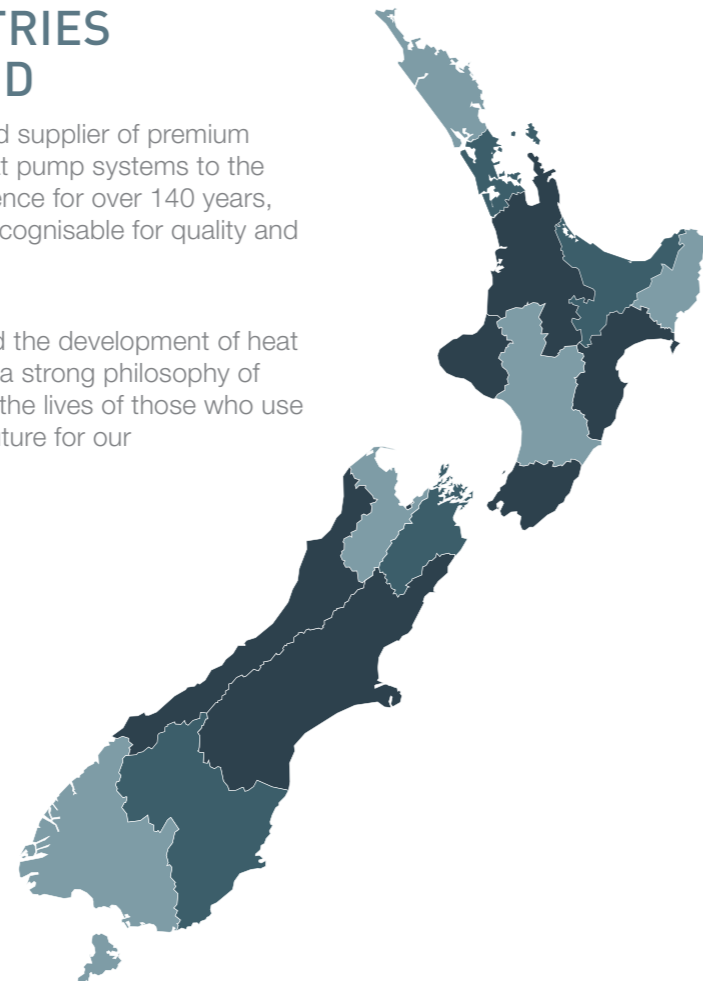

COMMITTED TO QUALITY

Standing behind the quality of our products is our commitment to our customers and our after sales service guarantees. Along with the rigorous quality assurance testing carried out on all our products, comprehensive warranties provide you with peace of mind.



DEDICATED LOCAL SUPPORT

Located in our Auckland head office, our dedicated customer service team are on hand to support our customers. Whether it's a question about our products, troubleshooting, warranty information or a user manual - our team of local experts are here to help.



5 YEARS PARTS AND LABOUR WARRANTY

Mitsubishi Heavy Industries focuses solely on manufacturing high performance heat pumps for the New Zealand market. All our systems are of the highest quality and are backed by a full 5 year parts and labour warranty.



ENERGY PERFORMANCE STANDARDS

To comply with New Zealand standards and deliver the most efficient solutions possible to our customers, all Mitsubishi Heavy Industries systems meet and exceed the Minimum Energy Performance Standards (MEPS).



MHI Split Systems

Our award winning split systems offer a quiet and highly energy efficient solution for heating and cooling individual rooms. They are comprised of an indoor unit which is installed on an interior wall or in your ceiling and an outdoor unit which is placed on an exterior wall of your home. All split systems come with a wireless remote control as standard.

Our split systems come in a variety of types (wall mounted, floor mounted and bulkhead), a range of capacities and both cool only and reverse cycle to suit any Kiwi home.

All our systems have undergone strict and rigorous testing and quality control measures to ensure they are of the highest standards and will withstand the tough New Zealand climate.



WALL MOUNTED

- Highly energy efficient
- Convenient features and functions
- Available in range of capacities
- Suitable for any home



FLOOR MOUNTED

- Energy efficient
- Convenient features and functions
- Perfect for colder climates



BULKHEAD

WHILE STOCKS LAST

- Super quiet operation
- Discreet design
- Perfect for renovations, new builds
- Convenient features and functions

Inside Our Condenser Technology

IMPROVED HEAT EXCHANGER

Our new and improved heat exchanger has been developed to improve refrigerant distribution and increase the systems effectiveness. The new design features a larger heat exchange area, boosting the unit's overall efficiency.

COATED PCB

To protect against humid weather a protective coating is applied to the circuit board in the outdoor unit, allowing it to withstand New Zealand's varying weather conditions and ensure the longevity of your system.

BLUE FIN TECHNOLOGY

Mitsubishi Heavy Industries outdoor units are coated with specially formulated layers that assist in preventing the hydrophilicity effect and reducing the rate of corrosion.

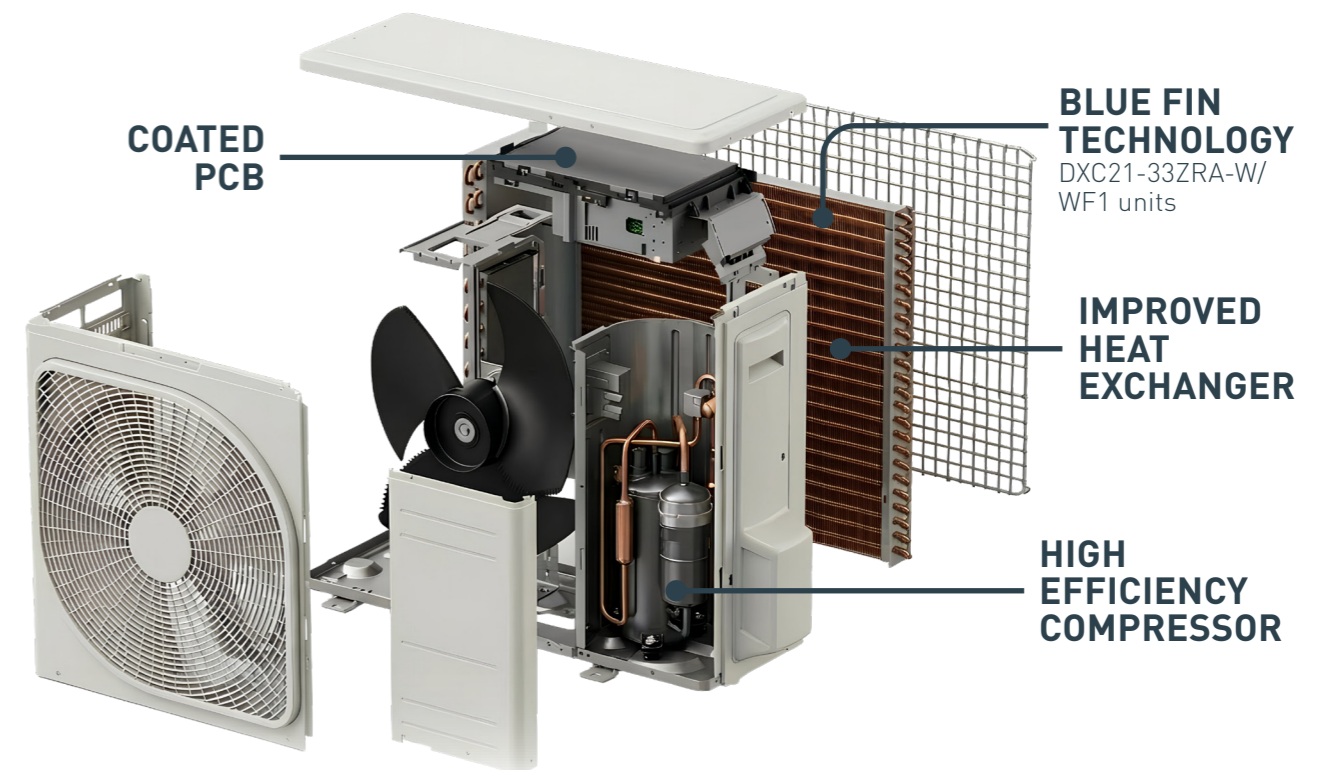

HIGH EFFICIENCY COMPRESSOR

One of the key features that provides Mitsubishi Heavy Industries air-conditioners with their powerful performance is our highly efficient compressor. Combined with a Neodymium motor that uses powerful, rare earth magnets, Mitsubishi Heavy Industries air-conditioners can deliver a higher motor efficiency while producing much less operational noise.

DC PAM INVERTER

The PAM control used in Mitsubishi Heavy Industries air-conditioners helps minimise the loss of electricity and boost the efficiency by allowing the unit to reach the temperature quickly before slowing down the compressor. This allows the unit to save energy while maintaining a comfortable temperature in the room.

WIDE OPERATION RANGE

With our advanced technology and high quality components, Mitsubishi Heavy Industries air-conditioners can operate in ambient outdoor temperatures as low as -20°C in heating mode and as high as $+46^{\circ}\text{C}$ in cooling mode.

This permits the installation in areas where the temperature conditions can be considered extreme.

Clean Air Technology



Mitsubishi Heavy Industries' Clean Air Technology is a combination of several different yet specialised components, systems and functions that are designed to work in synchronisation to help improve indoor air quality by removing allergens and odours and deactivating mould, bacteria and viruses*. Learn more at <https://mhiaa.mdz.com.au/clean-air-technology/>.

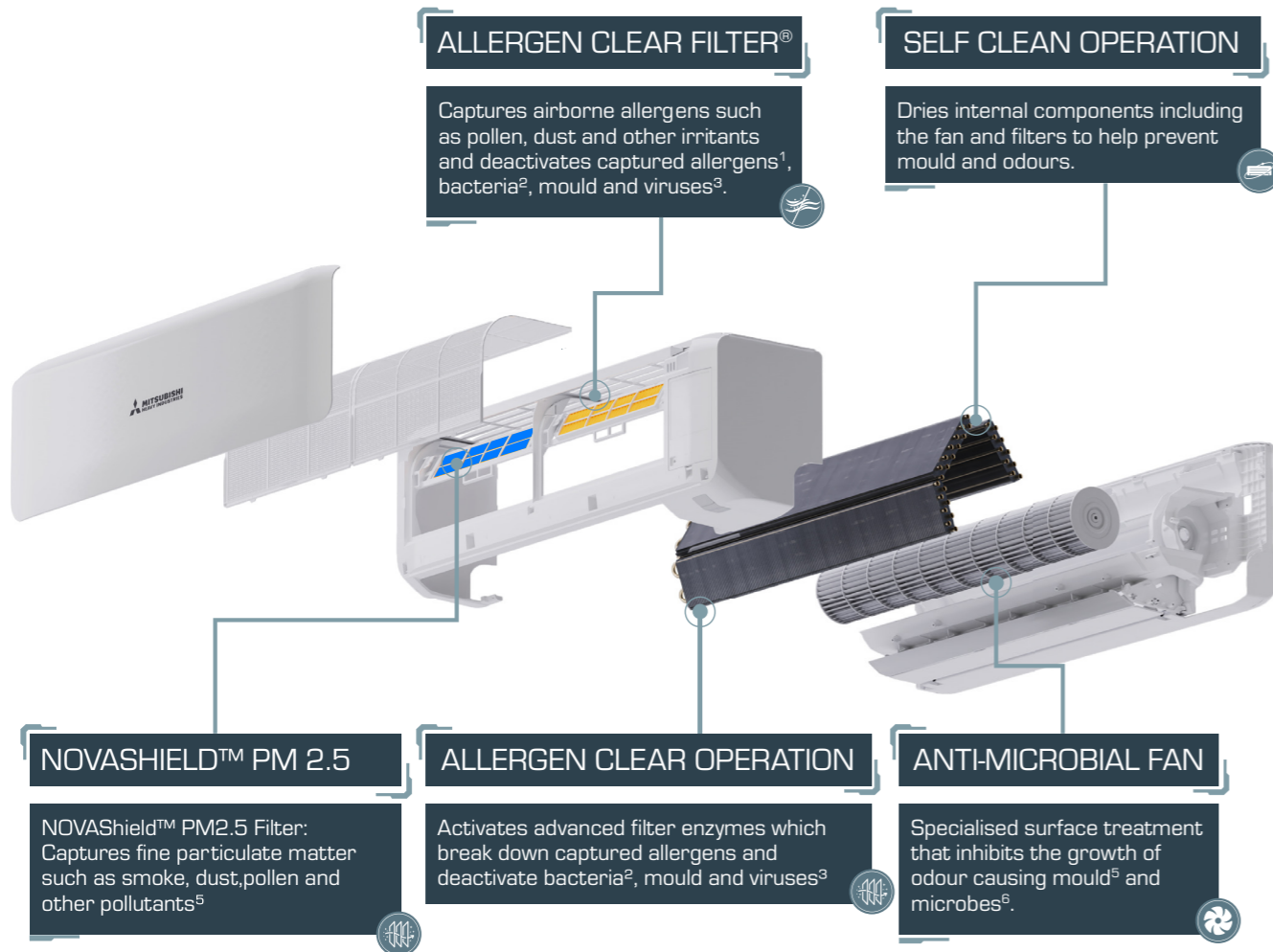

Recent tests have confirmed that the enzyme-urea compound contained within Mitsubishi Heavy Industries' Allergen Clear Filter is effective in the de-activation of SARS-CoV-2, the virus that causes COVID-19⁴.

99.998% OF SARS-COV-2 DEACTIVATED BY MHI'S ENZYME-UREA TECHNOLOGY CONTAINED WITHIN MHI'S ALLERGEN CLEAR FILTER®

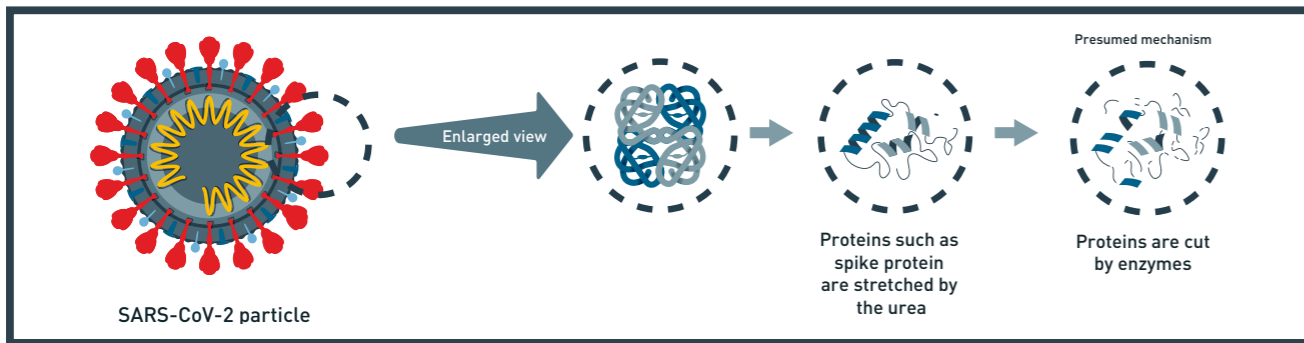

¹Excludes Ciara™ series
²Test method: ELISA colorimetric method Laboratory: Independent administrative agency national hospital mechanism Sagami Hospital, No.1536
³Test method: ELISA colorimetric method / ELISA fluorescent method Laboratory: Independent administrative agency national hospital mechanism Sagami Hospital, No.1536
⁴Test method: TCID (Infection value 50%) Laboratory: Foundation of Kitazato Environmental Science Center, No.15-0145
⁵Test method: Anti-viral test using severe acute respiratory syndrome coronavirus 2 (SARS-CoV-2) Laboratory: Japan Textile Products Quality and Technology Center Kobe Testing Center
⁶Available on Avanti WF1 Series and Bronte WF1 Series 6.3kW - 9.5kW

Air Conditioning Sizing Chart

A Class

Insulated roof space, walls and sub floor, full brick or brick veneer construction, average size windows with awnings, full shading south facing aspect, temperate weather conditions.

B Class

Insulated roof space, full brick or brick veneer construction, average size windows with internal shades, north facing aspect, temperate climate.

C Class

Insulated roof space, full brick or brick veneer construction, average size windows with internal shades, east facing aspect or sub tropical climate.

D Class

Little or no insulation, weatherboard, fibro or brick veneer construction, large windows, no shading from the sun westerly facing aspect.

| Selection Chart for Cooling and Heating | | | Room Class | | | |
|--|---------------|---------|--------------------------------------|----|----|----|
| Model | Capacity (kW) | | A | B | C | D |
| | | | Maximum Floor Area (m ²) | | | |
| Ciara™ (DXK05ZTLA-WFJ) | 1.5 | Cooling | 18 | 16 | 14 | 12 |
| | 2.0 | Heating | 16 | 14 | 12 | 10 |
| Avanti® (DXK06ZSA-WF1) | 2.0 | Cooling | 23 | 20 | 18 | 17 |
| | 2.7 | Heating | 20 | 18 | 16 | 14 |
| Ciara™ (DXK09ZTLA-WFJ) | 2.5 | Cooling | 28 | 24 | 21 | 19 |
| | 3.0 | Heating | 21 | 19 | 17 | 16 |
| Avanti® (DXK09ZSA-WF1) | 2.5 | Cooling | 28 | 24 | 21 | 19 |
| | 3.2 | Heating | 22 | 20 | 19 | 17 |
| Wera™ SRF-ZS (SRF25ZS-W) | 2.5 | Cooling | 28 | 24 | 21 | 19 |
| | 3.4 | Heating | 23 | 21 | 19 | 17 |
| Ciara™ (DXK12ZTLA-WFJ) | 3.3 | Cooling | 37 | 31 | 27 | 25 |
| | 3.8 | Heating | 29 | 27 | 24 | 20 |
| Avanti® (DXK12ZSA-WF1) | 3.5 | Cooling | 39 | 33 | 29 | 27 |
| | 3.7 | Heating | 28 | 25 | 23 | 20 |
| Wera™ (SRF35ZS-W) | 3.5 | Cooling | 39 | 33 | 29 | 27 |
| | 4.5 | Heating | 33 | 31 | 27 | 23 |
| Akari™ (SRR50ZS-W) | 5.0 | Cooling | 55 | 48 | 41 | 35 |
| | 5.4 | Heating | 39 | 36 | 32 | 28 |
| Avanti® (DXK18ZSA-WF1) Ciara™ (DXK18ZTLA-WFJ) | 5.0 | Cooling | 55 | 48 | 41 | 35 |
| | 5.8 | Heating | 41 | 37 | 34 | 30 |
| Wera™ (SRF50ZSX-W) | 5.0 | Cooling | 55 | 48 | 41 | 35 |
| | 6.0 | Heating | 42 | 38 | 35 | 31 |
| Akari™ (SRR60ZS-W) | 5.6 | Cooling | 60 | 51 | 45 | 39 |
| | 6.7 | Heating | 49 | 45 | 40 | 35 |
| Ciara™ (DXK21ZTLA-WFJ) | 6.3 | Cooling | 68 | 57 | 51 | 42 |
| | 7.1 | Heating | 52 | 48 | 42 | 38 |
| Bronte® (DXK24ZRA-WF1) Ciara™ (DXK24ZTLA-WFJ) | 7.1 | Cooling | 78 | 65 | 57 | 48 |
| | 8.0 | Heating | 58 | 52 | 48 | 42 |
| Bronte® (DXK28ZRA-WF1) | 8.0 | Cooling | 88 | 72 | 63 | 52 |
| | 9.0 | Heating | 64 | 59 | 52 | 47 |
| Bronte® (DXK33ZRA-WF1) | 9.5 | Cooling | 103 | 85 | 74 | 62 |
| | 10.3 | Heating | 72 | 67 | 61 | 56 |
| Bronte® (SRK100ZR-WF/SRK100ZRA-WF1) | 10.0 | Cooling | 107 | 91 | 81 | 71 |
| | 11.2 | Heating | 82 | 78 | 72 | 62 |

This guide has been developed to assist in heat pump selection for the majority of normal residential homes with standard ceiling height of 2.4m, and as per AS/NZS 3823 performance data. MHI recommends a heat load survey should be conducted by a qualified licensed installer. For R32 systems, minimum installation area for indoor unit and other AU/NZS Standards apply. Products are to be installed by a qualified licensed person only.

CIARA™ Series

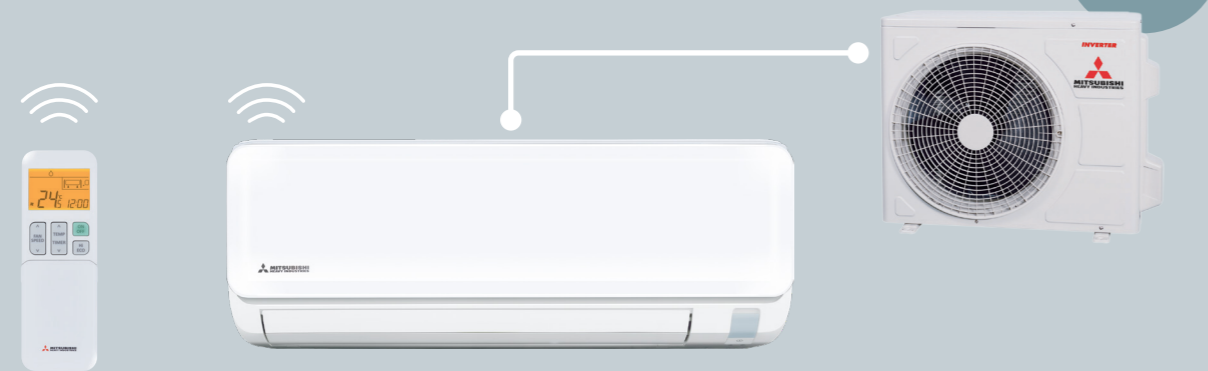

See pg. 16 -17 for full list of features and functions

BRONTE® WF1 Series

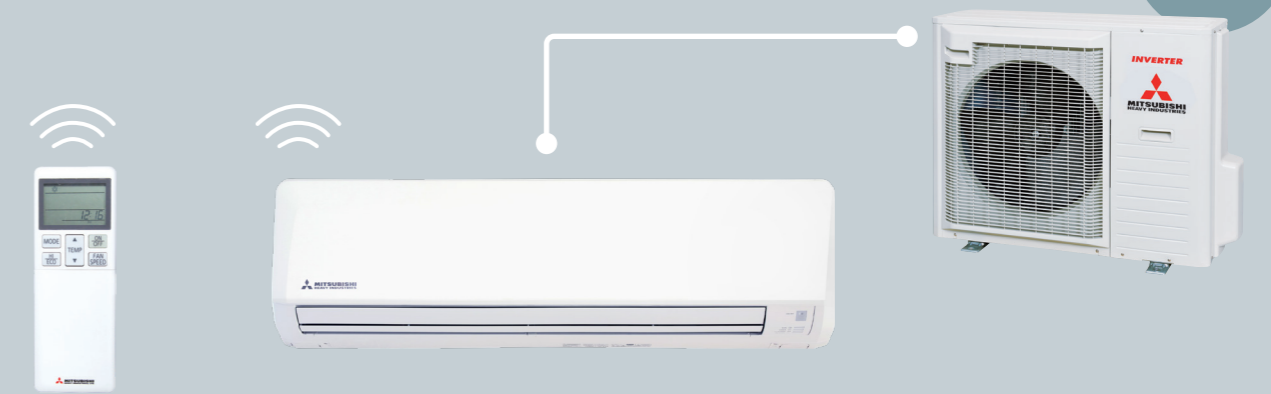

See pg. 18-19 for full list of features and functions

Wall Mounted 1.5kW | 2.0kW | 2.5kW | 3.3kW | 5.0kW | 6.3kW | 7.1kW

The NEW Ciara™ series of split systems incorporates stylish Italian design, with rounded contours and a sleek finish. Compact and lightweight, the Ciara™ series is packed with features including Wi-Fi built-in and Voice control compatibility. Available in reverse cycle models the Ciara™ series is perfect for small to medium spaces.

- BUILT-IN WI-FI**
Wi-Fi & voice control compatibility now included as standard*. Control your heat pump anywhere, anytime with your smartphone*.
- BACKLIT REMOTE CONTROL**
Easy to use remote with backlit screen for dark/night time operation. Accurate temperature control via 0.5°C increments.
- SILENT MODES**
Two levels of silent mode are available to further reduce the outdoor unit noise level.
- COMPACT DESIGN**
A compact and lightweight design allows for improved installation flexibility and installation into smaller spaces such as apartments.

| CIARA SERIES | | | 1.5kW | 2.0kW | 2.5kW | 3.3kW | 5.0kW | 6.3kW | 7.1kW |
|--------------------------------|---------|---------|------------|------------|-------------|------------|------------|------------|------------|
| Cooling Capacity | | | kW | | | | | | |
| | | | 1.5 | 2.0 | 2.5 | 3.3 | 5.0 | 6.3 | 7.1 |
| Heating Capacity | | | kW | | | | | | |
| | | | 2.0 | 2.7 | 3.0 | 3.8 | 5.8 | 7.1 | 8.0 |
| Star Energy Rating (GEMS 2019) | Hot | Cooling | ★★★★ (2.5) | ★★★★ (3.5) | ★★★★★ (4.0) | ★★★★ (3.5) | ★★★★ (3.0) | ★★★★ (3.5) | ★★★★ (3.5) |
| | | Heating | ★★★★ (3.5) | ★★★★ (3.5) | ★★★★ (3.5) | ★★★★ (3.5) | ★★★★ (3.0) | ★★★★ (3.0) | ★★★★ (3.0) |
| | Average | Cooling | ★★★ (2.0) | ★★★★ (2.5) | ★★★★ (3.0) | ★★★★ (3.0) | ★★★★ (3.0) | ★★★★ (3.5) | ★★★★ (3.0) |
| | | Heating | ★★★★ (3.0) | ★★★★ (3.0) | ★★★★ (3.0) | ★★★★ (3.0) | ★★★ (2.5) | ★★★ (2.5) | ★★★ (2.5) |
| | Cold | Cooling | ★ (1.5) | ★★★★ (2.5) | ★★★★ (3.0) | ★★★★ (3.0) | ★★★★ (3.0) | ★★★★ (3.5) | ★★★★ (3.5) |
| | | Heating | ★★★★ (3.0) | ★★★ (2.5) | ★★★ (2.5) | ★★★ (2.5) | ★★ (2.0) | ★★ (2.0) | ★★ (2.0) |

DXC05ZTLA-W outdoor unit shown.
*Voice control & voice commands available in conjunction with 3rd party smart devices such as Google Nest® or Amazon® Alexa® Devices.
Note: 1x user account per smartphone with up to 4x individual user accounts per individual Wi-Fi device
Some functions may not be available as voice commands or accessible via 3rd party apps.
Please check Apple App Store of Google Play for the latest operating system supported.

OTHER CONTROL OPTIONS (SOLD SEPARATELY)



Wall Mounted 8.0kW | 9.5kW | 10.0kW

Our renowned Bronte® Series is perfect for cooling and heating of larger spaces, and now it comes with the added convenience of built-in Wi-Fi control! Featuring advanced fan blade technology Bronte delivers industry leading, long reach airflow of up to 18m*. Available in reverse cycle, it's best suited for medium to larger spaces.

- BUILT-IN WI-FI & VOICE CONTROL**
AvantiPlus WF range includes built-in Wi-Fi and voice control compatibility^*. Access a range of functions remotely using your smartphone and the Smart M-Air App.
- JET AIR TECHNOLOGY**
Advanced blade technology used in development of jet engines to deliver industry leading long reach airflow of up to 18mtr*
- CLEAN AIR TECHNOLOGY**
Effectively capture fine particulate matter (PM2.5), including dust, pollen, smoke, and other pollutants with our NOVAShield™ Filter.†
- HIGH POWER OPERATION**
Provides 15mins of boosted power allowing you to quickly heat or cool your home before returning to normal operation.

| BRONTE SERIES | | | 8.0kW | 9.5kW | 10.0kW |
|--------------------------------|---------|---------|------------|------------|------------|
| Cooling Capacity | | | kW | | |
| | | | 8.0 | 9.5 | 10 |
| Heating Capacity | | | kW | | |
| | | | 9.0 | 10.3 | 11.2 |
| Star Energy Rating (GEMS 2019) | Hot | Cooling | ★★★★ (3.5) | ★★★★ (3.5) | ★★★★ (3) |
| | | Heating | ★★★ (3) | ★★★★ (3.5) | ★★★ (2.5) |
| | Average | Cooling | ★★★★ (3.5) | ★★★★ (3.5) | ★★★★ (2.5) |
| | | Heating | ★★★ (2.5) | ★★★ (2.5) | ★★ (1.5) |
| | Cold | Cooling | ★★★★ (3.5) | ★★★★ (3.5) | ★★★★ (3) |
| | | Heating | ★★ (2) | ★★ (2) | ★ (1) |

DXC24-28ZRA-W / SRC71-80ZRA-W outdoor unit shown.
*8.0kW - 10kW capacities in Cooling mode.
^Voice control & voice commands available in conjunction with 3rd party smart devices such as Google Nest® or Amazon® Alexa® Devices.
Note: 1x user account per smartphone with up to 4x individual user accounts per individual Wi-Fi device
Some functions may not be available as voice commands or accessible via 3rd party apps.
Please check Apple App Store of Google Play for the latest operating system supported.

OTHER CONTROL OPTIONS (SOLD SEPARATELY)



WERA™ Series



See pg. 16-17 for full list of features and functions

NOTES:

Floor Standing Systems 2.5kW | 3.5kW | 5.0kW

The Wera™ series of floor standing systems are the perfect solution when wall space is at a premium. The indoor unit is installed close to the floor and can be placed under a window, semi-recessed into the wall or mounted in a convenient location.



HIGH POWER OPERATION

Provides 15mins of boosted power allowing you to quickly heat or cool your home before returning to normal operation.



MEMORY LOUVRE

Set the louver at the desired angle. The unit will automatically return the louvres to this position on every subsequent start up.



SILENT OPERATION

Set periods of time where the unit will operate with even further reduced noise levels.



LOW TEMP PERFORMANCE

Continues to deliver high performance in temps as low as -20°C.

| WERA SERIES | | | 2.5kW | 3.5kW | 5.0kW |
|--------------------------------|---------|---------|------------|------------|------------|
| Cooling Capacity | | kW | 2.5 | 3.5 | 5.0 |
| Heating Capacity | | kW | 3.4 | 4.5 | 5.8 |
| Star Energy Rating (GEMS 2019) | Hot | Cooling | ★★★★ (4) | ★★★★ (4) | ★★★★ (3.5) |
| | | Heating | ★★★ (3.5) | ★★★ (3) | ★★★ (3) |
| | Average | Cooling | ★★★★ (3.5) | ★★★★ (3.5) | ★★★★ (3) |
| | | Heating | ★★★ (3) | ★★★ (2.5) | ★★★ (2.5) |
| | Cold | Cooling | ★★★★ (3.5) | ★★★★ (3.5) | ★★★★ (3) |
| | | Heating | ★★★ (2.5) | ★★ (2) | ★★ (2) |

SRC50ZSXA-W outdoor unit shown

OTHER CONTROL OPTIONS (SOLD SEPARATELY)



WIRED

Features and Functions

| | FEATURE/FUNCTION | DESCRIPTION | CIARA | BRONTE WF1 | WERA | |
|-------------------------|---------------------------|--|---|------------|------|---|
| COMFORT AND CONVENIENCE | Dry Operation | Reduces humidity by removing moisture from the air without affecting the indoor temperature. | ■ | ■ | ■ | |
| | Silent Operation | Set periods of time where the unit will operate with reduced noise levels, perfect for night time and an uninterrupted sleep. | ■ | ■ | ■ | |
| | Built-in Wi-Fi | Control your system anywhere, anytime with your smartphone via Wi-Fi & voice control included as standard | ■ | ■ | ■ | |
| | Night Setback | Designed for the colder seasons, this function ensures the room temperature is kept at around 10°C, even while unoccupied. | ■ | ■ | ■ | |
| | Comfort Start-up | When using the ON-TIMER function, the unit will switch on slightly earlier than the SET time, to ensure the optimum temperature is reached at the ON TIME. | ■ | ■ | ■ | |
| | Weekly Timer | Set up to 4 timer operations a day (max 28 per week). Once set, the unit will turn on and off at the specified times of the day repeatedly. | ■ | ■ | ■ | |
| | Sleep Timer | Set a pre-determined amount of time between 30 and 240 mins that your unit will operate for before switching off. | ■ | ■ | ■ | |
| | On/Off Timer | Set your unit to turn on and off once, at specific times, within a 24 hour period. Unit will then turn on and off at the specified times every day. | ■ | ■ | ■ | |
| | Preset Operation | The desired preset operation mode can be enabled with a single touch of a button. | ■ | ■ | ■ | |
| | Child Lock | Lock the remote control to prevent little ones from changing functions and other settings. Useful for families with curious young children. | ■ | ■ | ■ | |
| | LED Brightness Adjustment | Adjust the brightness of the LED display on the indoor unit to minimise disturbance and ensure a good nights sleep. | ■ | ■ | ■ | |
| | Auto Operation | The unit will automatically select from heating, cooling or dry operation mode. | ■ | ■ | ■ | |
| | MAINTENANCE & PREVENTION | Microcomputer-Operated Defrosting | Automatically activated during low ambient temperatures to prevent the frosting of the outdoor heat exchanger. | ■ | ■ | ■ |
| | | Self-Diagnostic Function | In the unlikely event of a fault the internal microcomputer automatically runs a diagnostic of the system. This enables a service agent to quickly isolate and repair any issues. | ■ | ■ | ■ |
| Back-up Switch | | If the remote control fails, the unit can be operated via an on/off switch on the indoor unit. | ■ | ■ | ■ | |
| Auto Restart Function | | If there is a temporary loss of power, the unit will automatically restart in the same operating mode it was in when power is restored. | ■ | ■ | ■ | |
| Removable Cover Panel | | Removable front cover allowing access for easy maintenance and cleaning. | ■ | ■ | ■ | |

*Weekly timers only available via the Smart M-Air app for Ciara series

Features and Functions

| | FEATURE/FUNCTION | DESCRIPTION | CIARA | BRONTE WF1 | WERA | |
|-------------------------|---|--|--|------------|------|---|
| ENERGY SAVING | Fuzzy Auto Mode | Uses algorithms to determine the best operating mode, temperature and automatically adjusts the inverter frequency. | ■ | ■ | ■ | |
| | Eco Operation (Avanti PLUS®) | Automatically adjusts the set temperature based on the detected human activity and switches the unit off when no activity is detected. | ■ | ■ | ■ | |
| | Economy Mode | The unit operates at a slightly reduced capacity to reduce power consumption while maintaining a comfortable room temperature. | ■ | ■ | ■ | |
| AIRFLOW | Jet Air Technology | Advanced fan blade technology, used in the development of jet engines, efficiently delivers a powerful yet quiet and evenly distributed airflow | ■ | ■ | ■ | |
| | High Power Operation | Provides 15mins of boosted power to quickly heat or cool your home. Perfect for when you first turn on the unit. | ■ | ■ | ■ | |
| | 3D Auto | Activates three independent motors which effectively and efficiently distributes an even airflow. | ■ | ■ | ■ | |
| | Auto Louvre Mode | Depending on whether the unit is in heating or cooling mode this will automatically set the louvre at the optimum angle for even air distribution. | ■ | ■ | ■ | |
| | Memory Louvre | Set the louvre at the desired angle. The unit will automatically return the louvres to this position on every subsequent start up. | ■ | ■ | ■ | |
| | Up/Down Louvre Swing | The horizontal louvres will automatically swing up and down for even air distribution. | ■ | ■ | ■ | |
| | Right/Left Louvre Swing | The vertical louvres will automatically swing left and right for even air distribution. | ■ | ■ | ■ | |
| | Air Outlet Selection | Select whether the airflow is distributed via the upper outlet, the lower outlet or both. | ■ | ■ | ■ | |
| | Positioning of Installation | Manually set the horizontal airflow direction to ensure even air distribution in situations where the indoor unit is installed in close proximity to a wall. | ■ | ■ | ■ | |
| | CLEAN AIR TECHNOLOGY | Allergen Clear Operation | Multi-stage operation that activates filter enzymes, neutralising captured allergens such as pollen, dust and hair. | ■ | ■ | ■ |
| | | Self-Clean Operation | Dries the indoor unit components by running the fan on ultra-low mode, preventing the growth of mould. Designed to be run regularly after use. | ■ | ■ | ■ |
| | | Photocatalytic Deodorizing Filter | Easy to clean filter that catches airborne particles before neutralising the odour causing molecules within them. | ■ | ■ | ■ |
| NovaShield PM2.5 Filter | | Captures fine particulate matter such as smoke, dust, pollen and other pollutants. | ■ | ■ | ■ | |
| Allergen Clear Filter | | Captures airborne allergens such as hair, pollen and dust particles before neutralising them and any bacteria using specially formulated enzymes. | ■ | ■ | ■ | |
| Anti-Microbial Fan | Specialised surface treatment that inhibits the growth of odour causing mould and microbes. | ■ | ■ | ■ | | |

CIARA™ SERIES - ZTLA-WFJ MODELS



| CAPACITY | | 1.5kW | 2.0kW | 2.5kW | 3.3kW | 5.0kW | 6.3kW | 7.1kW | |
|----------------------------------|---|---------------------------|------------------|---|------------------|------------------|------------------|---|--------------------|
| Indoor | Power Source (Outdoor Unit) | DXK05ZTLA-WFJ | DXK07ZTLA-WFJ | DXK09ZTLA-WFJ | DXK12ZTLA-WFJ | DXK18ZTLA-WFJ | DXK21ZTLA-WFJ | DXK24ZTLA-WFJ | |
| | | DXC05ZTLA-WJ | DXC07ZTLA-WJ | DXC09ZTLA-WJ | DXC12ZTLA-WJ | DXC18ZTLA-WJ | DXC21ZTLA-WJ | DXC24ZTLA-WJ | |
| Outdoor | Nominal Capacity (Range) | 1.5 (0.7-2.5) | 2.0 (0.7-2.8) | 2.5 (0.8-3.2) | 3.3 (0.8-3.7) | 5.0 (1.3-5.3) | 6.3 (1.2-7.1) | 7.1 (1.2-7.3) | |
| | Power Consumption | Heating H1 | 2.0 (0.9-4.1) | 2.7 (0.9-4.2) | 3.0 (1.0-4.8) | 3.8 (1.0-4.9) | 5.8 (1.3-6.3) | 7.1 (1.0-8.5) | 8.0 (1.1-9.4) |
| | | Heating H2 | 3.1 | 3.05 | 3.7 | 3.7 | 4.6 | 6.6 | 7.42 |
| | Maximum Power Consumption | Cooling T1 | 0.35 (0.20-0.85) | 0.51 (0.20-0.92) | 0.58 (0.19-0.95) | 0.90 (0.19-1.30) | 1.59 (0.29-1.77) | 1.84 (0.27-2.39) | 2.27 (0.28 - 2.67) |
| | | Heating H1 | 0.42 (0.21-1.39) | 0.64 (0.21-1.40) | 0.66 (0.21-1.48) | 0.90 (0.21-1.50) | 1.62 (0.27-2.04) | 2.01 (0.25-2.89) | 2.30 (0.26 - 3.42) |
| | Running Current | Maximum Power Consumption | 1.55 | 1.55 | 1.65 | 1.65 | 2.25 | 3.2 | 3.8 |
| | | Cooling T1 | 1.90 | 2.7 | 3.1 | 4.1 | 6.7 | 7.7 | 9.6 |
| | Inrush Current, Maximum Current | Heating H1 | 2.30 | 3.4 | 3.5 | 4.1 | 6.8 | 8.5 | 9.7 |
| | | Heating H1 | 2.4-9.0 | 3.5-9.0 | 3.6-9.0 | 4.9-9.0 | 5.0-14.5 | 5.0-17 | 5.0-17 |
| | Sound Power Level (JIS C9612) | EER | 4.29 | 3.92 | 4.31 | 3.67 | 3.14 | 3.42 | 3.13 |
| Heating H1 | | 4.76 | 4.22 | 4.55 | 4.22 | 3.58 | 3.53 | 3.48 | |
| Sound Pressure Level (JIS C9612) | Outdoor | 56 | 57 | 58 | 61 | 64 | 64 | 67 | |
| | Indoor | 36-30-23-19 | 37-31-23-19 | 41-36-26-22 | 45-37-27-22 | 47-40-32-25 | 46-43-38-30 | 49-44-39-31 | |
| Energy Label (GEMS 2019) | Hot | 43 | 45 | 47 | 50 | 52 | 52 | 55 | |
| | Average | 2.5 | ★★★(3.5) | ★★★★(4) | ★★★★(3.5) | ★★★★(3) | ★★★★(3.5) | ★★★★(3.5) | |
| External dimensions (HXWXD) | Cold | 3 | ★★★(2.5) | ★★★★(2.5) | ★★★★(2.5) | ★★★★(2) | ★★★★(2) | ★★★★(2) | |
| | Indoor | 294x798x210 | 294x798x210 | 294x798x210 | 294x798x210 | 294x798x210 | 294x998x230 | 294x998x230 | |
| Net weight | Outdoor | 540x645(+57)x275 | 540x645(+57)x275 | 540x645(+57)x275 | 540x645(+57)x275 | 595x780(+62)x290 | 640x800(+71)x290 | 640x800(+71)x290 | |
| | Indoor | 8 | 8 | 8.5 | 8.5 | 9 | 11.5 | 11.5 | |
| Airflow | Cooling (Indoor) | 22 | 22 | 24 | 24 | 32 | 41 | 41 | |
| | Heating (Indoor) | 158-125-82-63 | 165-130-82-63 | 167-133-88-73 | 187-142-90-73 | 208-173-120-90 | 283-245-202-157 | 320-253-210-157 | |
| Installation Data | Quantity | 167-145-97-73 | 173-152-103-73 | 183-157-108-83 | 197-163-113-83 | 210-192-148-107 | 307-287-235-193 | 345-295-243-193 | |
| | Pre-Charged to Pipe | (R32) 0.43 | (R32) 0.43 | (R32) 0.59 | (R32) 0.59 | (R32) 0.9 | (R32) 1.20 | (R32) 1.20 | |
| Standard accessories | Refrigerant Piping | 10 | 10 | 10 | 10 | 15 | 15 | 15 | |
| | Connection Method | Ø6.35 | Ø6.35 | Ø6.35 | Ø6.35 | Ø6.35 | Ø6.35 | Ø6.35 | |
| Optional parts | Max Vertical Height Diff. Between O.U. and I.U. | Ø9.52 | Ø9.52 | Ø9.52 | Ø9.52 | Ø12.7 | Ø12.7 | Ø12.7 | |
| | Demand Response (AS4755) | 20 | | 20 (O.U. above I.U.) / 15 (O.U. below I.U.) | | 25 | | 20 (O.U. above I.U.) / 20 (O.U. below I.U.) | |
| Demand Response (AS4755) | Interface kit (SC-BIKN2-E) / Photocatalytic Washable Deodorizing Filter | No | | Interface kit (SC-BIKN2-E) / Photocatalytic Washable Deodorizing Filter | | Yes | | Yes | |

* Operation data has been gathered in accordance with AS/NZS 3823 standards. For testing conditions please refer to Page 23.

PRODUCT SPECIFICATIONS

BRONTE® WF1 SERIES



| CAPACITY | | 8.0kW | 9.5kW | 10.0kW | 10.0kW | 10.0kW | |
|----------------------------------|---|---|-----------------------------|---|------------------|---|------------------|
| Indoor | Power Source (Outdoor Unit) | SRK60ZRA-WF1 / DXK28ZRA-WF1 | SRK95ZRA-WF1 / DXK33ZRA-WF1 | SRK100ZRA-WF1 | SRK100ZRA-WF1 | SRK100ZRA-WF1 | |
| | | SDC80ZRA-W / DXC28ZRA-W | SRC95ZRA-W / DXC33ZRA-W | FDCA100VNA-W | FDCA100VNA-W | FDCA100VSA-W | |
| Outdoor | Nominal Capacity (Range) | 8.0 (2.3-9.5) | 9.5 (2.5-10.6) | 10.0 (4.0-11.2) | 10.0 (4.0-11.2) | 10.0 (4.0-11.2) | |
| | Power Consumption | Heating H1 | 9.0 (2.1-11.2) | 10.3 (3.2 -11.9) | 11.2 (4.0 -12.5) | 11.2 (4.0 -12.5) | 11.2 (4.0 -12.5) |
| | | Heating H2 | 8.2 | 9.6 | 7.7 | 7.7 | 7.7 |
| | Maximum Power Consumption | Cooling T1 | 2.22 (0.48-3.1) | 2.56 (0.5-3.2) | 3.19 | 3.19 | 3.19 |
| | | Heating H1 | 2.40 (0.40-3.40) | 2.64 (0.6-3.7) | 3.04 | 3.04 | 3.04 |
| | Running Current | Maximum Power Consumption | 3.65 | 3.80 | 6.4 | 6.4 | 10.20 |
| | | Cooling T1 | 9.4 | 10.8 | 14.3 | 14.3 | 4.8 |
| | Inrush Current, Maximum Current | Heating H1 | 10.2, 17.0 | 11.1, 17.5 | 5, 24 | 5, 24 | 5, 15 |
| | | Heating H1 | 3.60 | 3.71 | 3.13 | 3.13 | 3.13 |
| | Sound Power Level (JIS C9612) | Outdoor | 3.75 | 3.90 | 3.68 | 3.68 | 3.68 |
| Indoor | | 68 | 69 | 69 | 69 | 69 | |
| Sound Pressure Level (JIS C9612) | Indoor | 46-43-38-25 | 48-45-40-26 | 48-45-40-27 | 48-45-40-27 | 48-45-40-27 | |
| | Outdoor | 56 | 57 | 54 | 54 | 54 | |
| Energy Label (GEMS 2019) | Hot | ★★★(3.5) | ★★★★(3.5) | ★★★★(3) | ★★★★(3) | ★★★★(3) | |
| | Average | ★★★(3) | ★★★★(3.5) | ★★★★(2.5) | ★★★★(2.5) | ★★★★(2.5) | |
| External dimensions (HXWXD) | Cold | ★★★(2.5) | ★★★★(2.5) | ★★★★(1.5) | ★★★★(1.5) | ★★★★(1.5) | |
| | Indoor | ★★★(2) | ★★★★(2) | ★★★★(3) | ★★★★(3) | ★★★★(3) | |
| Net weight | Indoor | 339x1197x262 | 339x1197x262 | 339x1197x262 | 339x1197x262 | 339x1197x262 | |
| | Outdoor | 750x880(+88)x340 | 845x970(+89)x370 | 845x970x370 | 845x970x370 | 845x970x370 | |
| Airflow | Indoor | 15.5 | 16.5 | 16.5 | 16.5 | 16.5 | |
| | Outdoor | 58 | 69 | 77 | 78 | 78 | |
| Installation Data | Quantity | 383-345-300-182 | 408-355-293-173 | 408-355-293-173 | 408-355-293-173 | 408-355-293-173 | |
| | Pre-Charged to Pipe | 450-363-315-234 | 458-386-318-227 | 458-386-318-227 | 458-386-318-227 | 458-386-318-227 | |
| Standard accessories | Refrigerant Piping | (R32) 1.6 | (R32) 2.0 | (R32) 3.3 | (R32) 3.3 | (R32) 3.3 | |
| | Connection Method | 15 | 15 | 30 | 30 | 30 | |
| Demand Response (AS4755) | Max Vertical Height Diff. Between O.U. and I.U. | Ø6.35 | Ø9.52 | Ø9.52 | Ø9.52 | Ø9.52 | |
| | | Ø15.88 | Ø15.88 | Ø15.88 | Ø15.88 | Ø15.88 | |
| Demand Response (AS4755) | Interface kit (SC-BIKN2-E) | 30 | | 50 | | 50 | |
| | | 20 (O.U. above I.U.) / 20 (O.U. below I.U.) | | 50 (O.U. above I.U.) / 15 (O.U. below I.U.) | | 50 (O.U. above I.U.) / 15 (O.U. below I.U.) | |
| Demand Response (AS4755) | Allergen Clear Filter & NOVAShield® PM 2.5 Filter, Built-in Wi-Fi | Allergen Clear Filter & NOVAShield® PM 2.5 Filter, Built-in Wi-Fi | | Allergen Clear Filter & NOVAShield® PM 2.5 Filter, Built-in Wi-Fi | | Allergen Clear Filter & NOVAShield® PM 2.5 Filter, Built-in Wi-Fi | |
| | | Interface kit (SC-BIKN2-E) | | Interface kit (SC-BIKN2-E) | | Interface kit (SC-BIKN2-E) | |

* Operation data has been gathered in accordance with AS/NZS 3823 standards. For testing conditions please refer to Page 27.

PRODUCT SPECIFICATIONS
WERA™ SERIES

| CAPACITY | | 2.5kW | 3.5kW | 5.0kW |
|---|---|---|---|---|
| Indoor | | SRF25ZS-W | SRF35ZS-W | SRF50ZSX-W |
| Outdoor | | SRC25ZSA-W | SRC35ZSA-W | SRC50ZSXA-W |
| Power Source (Outdoor Unit) | | | 1 Phase 240V 50Hz | |
| Nominal Capacity (Range) | Cooling T1 | 2.5 (0.9-3.2) | 3.5 (0.9-4.1) | 5.0 (1.1-5.6) |
| | Heating H1 | | | |
| | Heating H2 | 3.4 (0.9-4.7) | 4.5 (0.8-5.2) | 6.0 (0.8-7.4) |
| | Cooling T1 | 3.45 | 3.80 | 5.60 |
| | Heating H1 | 0.50 (0.17-0.82) | 0.82 (0.18-1.33) | 1.32 (0.19-1.90) |
| Power Consumption | | 0.74 (0.19-1.29) | 1.12 (0.19-1.53) | 1.58 (0.19-2.34) |
| | Maximum Power Consumption | 1.65 | 1.65 | 2.90 |
| *Operation Data | Running Current | 2.5 | 3.7 | 5.6 |
| | Inrush Current, Maximum Current | 3.4 | 4.9 | 6.6 |
| EER | Cooling T1 | 3.6, 9.0 | 5.0, 9.0 | 5.0, 15.0 |
| | Heating H1 | 5.00 | 4.27 | 3.79 |
| COP | Heating H1 | 4.59 | 4.02 | 3.80 |
| | Outdoor | 60 | 63 | 63 |
| Sound Power Level (JIS C9612) | Indoor | 37-32-29-26 | 40-35-33-29 | 46-38-33-28 |
| | Outdoor | 46 | 50 | 51 |
| Energy Label (GEMS 2019) | Hot | ★★★★ (4) | ★★★★ (4) | ★★★★ (3.5) |
| | Heating | ★★★★ (3.5) | ★★★ (3) | ★★★★ (3) |
| | Cooling | ★★★★ (3.5) | ★★★★ (3.5) | ★★★★ (3) |
| | Heating | ★★★★ (3) | ★★★★ (2.5) | ★★★★ (2.5) |
| | Cold | ★★★★ (3.5) | ★★★★ (3.5) | ★★★★ (3) |
| External dimensions (HXWXD) | Indoor | 600x860x238 | 600x860x238 | 600x860x238 |
| | Outdoor | 540x780(+62)x290 | 540x780(+62)x290 | 640x800(+71)x290 |
| Net weight | Indoor | 18 | 19 | 19 |
| | Outdoor | 34.5 | 34.5 | 45 |
| Airflow | Cooling (Indoor) | 150-126-111-96 | 153-130-121-106 | 192-160-123-110 |
| | Heating (Indoor) | 175-136-128-110 | 178-138-135-123 | 200-167-157-127 |
| Refrigerant (Type, Amount, Pre-charge Length) | Quantity | (R32) 0.78 | (R32) 0.78 | (R32) 1.30 |
| | Pre-Charged to Pipe | 15 | 15 | 15 |
| Installation Data | Refrigerant Piping | Ø6.35 (1/4") | Ø6.35 (1/4") | Ø6.35 (1/4") |
| | Connection Method | Ø9.52 (3/8") | Ø9.52 (3/8") | Ø12.7 (1/2") |
| Standard accessories | Maximum Pipe Length (One Way) | | Flare connection | |
| | Max Vertical Height Diff. Between O.U. and I.U. | 20 | 20 | 20 |
| Optional parts | | 10 (O.U. above I.U.) / 10 (O.U. below I.U.) | Allergen Clear & Photocatalytic Washable Deodorizing Filter | 20 (O.U. above I.U.) / 20 (O.U. below I.U.) |
| Demand Response (AS4755) | | Yes | Interface kit (SC-BIKN2-E) / Wi-Fi Kit | Yes |

* Operation data has been gathered in accordance with AS/NZS 3823 standards. For testing conditions please refer to Page 22.

TESTING CONDITIONS

| Item | Indoor Air Temperature | | Outdoor Air Temperature | | Standards |
|-----------|------------------------|------|-------------------------|------|--------------|
| | DB | WB | DB | WB | |
| Operation | 27°C | 19°C | 35°C | 24°C | AS/NZ 3823.2 |
| Cooling | 20°C | - | 7°C | 6°C | |

- (1) The data is measured at the conditions mentioned in the table to the left.
- (2) The air-conditioner is manufactured and tested in conformity with the AS/NZS.
- (3) Sound level indicates the value in an anechoic chamber. During operation these values are somewhat higher due to ambient conditions.
- (4) Select the breaker size according to applicable national standard.
- (5) The operation data indicates when the air-conditioner is operated at 240V 50Hz.

*(1) The data is measured at the following conditions:

mhiheatpumps.co.nz G.S.T. 105-673-620

New Zealand: Phone: **0800 138 007**

Auckland 95 Manukau Road, Epsom, Auckland, 1023

Mitsubishi Heavy Industries Air-conditioners Australia, Pty. Ltd.
New Zealand Branch

MOVE THE WORLD FORWARD  **RD MITSUBISHI
HEAVY
INDUSTRIES
GROUP**